

## Extended Power Protection for Mission-Criticals



The Professional Tower Series UPS provides advanced level of power protection to servers, telecom equipments, VOIP, internet working hardware and other mission-critical applications. Featuring Pure Sinewave output and Automatic Voltage Regulation (AVR) stabilizes the AC signal and maintains a safe voltage, it allows the UPS to maintain safe power levels for the connected equipment without resorting to battery power. Its detachable, remote-controllable Multifunction LCD Readout can be mounted on the wall or in the control center nearby to provide highest convenience and flexibility under different management scenarios.

The optional SNMP/HTTP Remote Management Capability enables remote management and control of the system through standard web browser. Together with the included PowerPanel® Business Edition management software, it could provide corporate servers and critical workstations comprehensive network power management including unattended-shutdown, event logging, reporting, and notifications.



### Applications

- Home and Home Office
- Home Theater System
- Small Office
- Networking, Servers & Workstations

### Series Features

- GreenPower UPS™ Technology
- Pure Sine Wave Output
- Line-Interactive UPS Topology
- Automatic Voltage Regulator (AVR)
- EMI, RFI, Surge and Lightning Spike Protection
- Auto-Restart/Auto-Charge
- Emergency Power Off (EPO) Port
- Multifunction LCD Readout
- USB & Serial Connectivity Ports
- User-Replaceable Batteries
- SNMP/HTTP Remote Management Capability (Optional)
- PowerPanel® Business Edition Software

Energy-Saving	Pure Sine Wave	EPO Port
SNMP /HTTP	LCD Display	Detachable LCD

### Pure Sine Wave Output

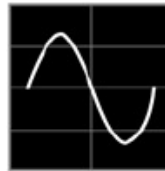

For applications that require Pure *Sine Wave* power, CyberPower provides UPS models with True Sine Wave output, also known as *Pure Sine Wave*. They are designed for electronic devices that have *Power Factor Correction* (PFC) Power Supplies as well as for small AC motors and other devices that need true sine-wave power in order to function properly.

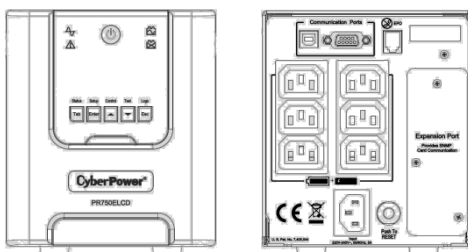

Front

Back

### PowerPanel® Business Edition Management S/W

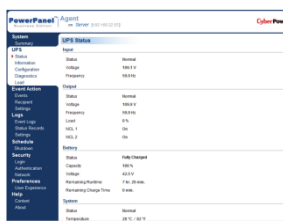

**AUTO-SHUTDOWN SOFTWARE**  
CyberPower PowerPanel® Business Edition Management Software, is compatible with Windows7, Vista, XP, 2000 Pro., ME, 98, Windows Server 2008, 2003, Mac and Linux.

\*Software functions may vary due to firmware version and/or hardware constraints.

# Smart App Professional Tower Series

PR750ELCD

**CyberPower**<sup>®</sup>  
Reliability. Quality. Value.

## Technical Specification

Model	PR750ELCD
<b>Configuration</b>	
Capacity (VA / Watts)	750/675
Energy-Saving Technology	Yes
<b>Input</b>	
Frequency Range	47 Hz - 63 Hz (Auto Sensing)
Input Plug Type	IEC 320 C14
<b>Output</b>	
UPS Outlets (Numbers)	(6) IEC
On Battery Output Voltage	Pure Sine Wave at 230 Vac +/- 5%
On Battery Output Frequency	50/60Hz +/- 1%
Overload Protection	Circuit Breaker / Internal Current Limiting
AVR	Double Boost, Single Buck
<b>Surge Protection and Filtering</b>	
Surge Protection	Yes
<b>Physical</b>	
Dimensions (H x W x D) (mm)	162 x 349 x 138
Weight (kg)	12.3
<b>Battery</b>	
Sealed Maintenance Free Lead Acid Battery	12V/7AH x 2
User Replaceable	Yes
Typical Recharge Time	8 Hours
<b>Runtimes</b>	
Half-load / Full-load (mins)	4/12
<b>Status Indicators</b>	
Indicators	Power On, Line Mode, On Battery, Fault, Replace Battery, LCD Display
Audible Alarms	Battery Discharge, Battery Low, Fault, Overload
Multi-function LCD Readout	Yes
<b>Communication</b>	
PowerPanel <sup>®</sup> Business Edition	Windows 7 / Vista / XP / 2000, Server 2003 / 2008, Linux
<b>Management</b>	
Self Test	Yes
Auto-Charge / Auto-Restart	Yes
Connectivity Ports	USB, Serial
SNMP/HTTP Capable	Optional

#All specifications are subject to change without notice. ©2012 CyberPower Systems. All Trademarks are the property of their owners.

## Packaging Content

- Main Unit
- Software CD-ROM
- USB A+B Type Cable
- IEC I/P Power Cord x 1
- User Manual
- EPO Cable
- Serial Cable (DB-9) x 1
- Function Setup Guide x 1



DISTRIBUTED BY:

CyberPower's  
Manufacturing  
Facilities are  
ISO 9001:2000,  
ISO 14000, and  
QC080000  
Approved